

This quick start guide is intended to be used as an easy reference in conjunction with and **NOT IN PLACE OF** your operator's manual.

READ AND UNDERSTAND your operator's manual; it contains important information regarding assembly, installation, care, and warranty. Accessories are referenced in the operator's manual, if needed for your application. Some states and localities have regulations that may involve a permit to use Lake Groomer; always comply with local requirements. Contact your dealer or Lake Groomer directly with any questions.

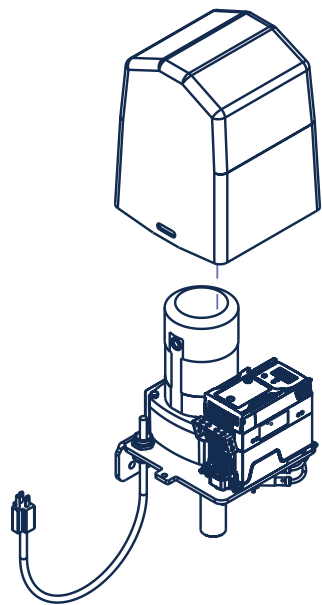

STEP 1:

Take out the upper drive assembly from box 1. Remove the packaging under the cover. Locate a 110/120-volt, 15/20-amp outlet. Using a 12-gauge outdoor-rated power cord, plug the Lake Groomer in to ensure it is working as intended and no damage has occurred during shipping.

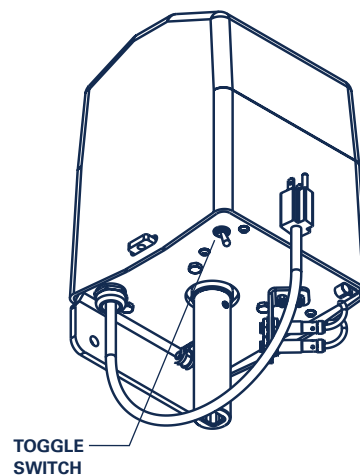

STEP 2:

Flip the toggle switch on. The device will rotate in one direction. Then, flip the toggle switch off and wait 3-5 seconds. Flip the toggle switch back on and notice the device rotates in the opposite direction. Ensure that the device rotates in both directions.

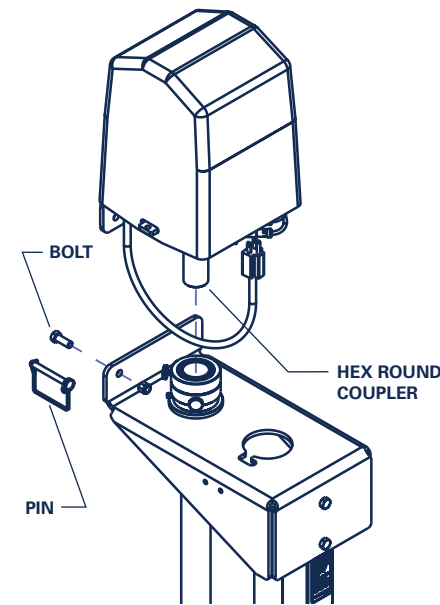

STEP 3:

The upper drive assembly can be detached from the lower drive assembly for easier installation or transportation. This will help avoid getting the upper drive wet, which may damage the electronics. The unit comes with a quick pin connection and 3/8-inch x 1-inch bolt. Utilize the 3/8-inch x 1-inch bolt for best performance. Use the quick pin connection for convenience if you plan on removing the upper drive consistently.

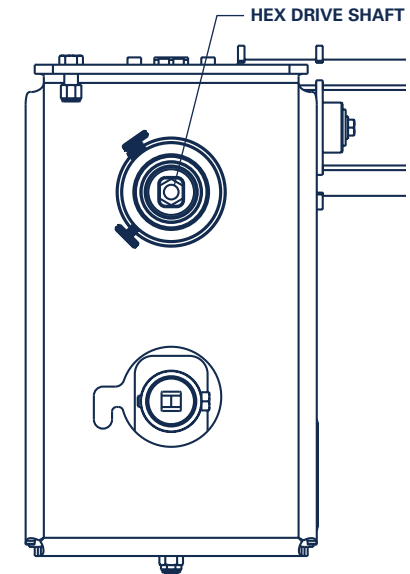

STEP 4:

To reattach the upper drive assembly, align the hex round coupler and the hex drive shaft, then drop the upper drive back into place and replace the quick pin or the 3/8-inch x 1-inch bolt. It may be necessary to rotate the coupler until it is aligned. **Refer to page 27 in your operator's manual.**

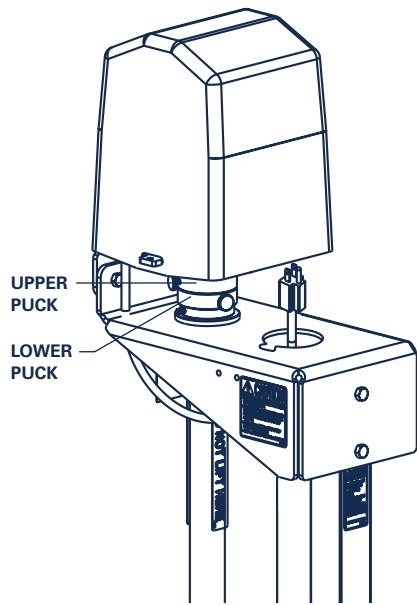

STEP 5:

Locate the two directional pucks near the sensors on the upper drive assembly; these control the clockwise and counterclockwise rotation of the rollers. The directional pucks have thumbscrews that are used to lock the pucks in place, as well as trip the sensors to switch directions. When the upper thumb screw passes the upper sensor, the device changes from a clockwise to counterclockwise direction. **Refer to pages 12 and 13 in your operator's manual.**

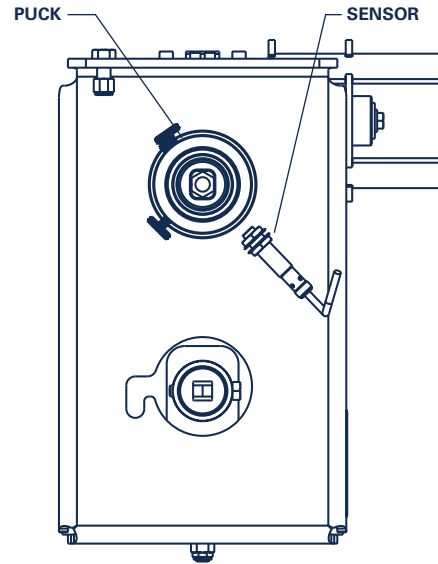

STEP 6:

Turn on the device. Notice the direction the cage is turning. If the device is rotating clockwise, loosen the top thumb screw and align it with the sensor. The sensor will turn on, and the device will stop and change direction. If the device is rotating counterclockwise, loosen the bottom thumb screw and align it with the sensor. The sensor will turn on, and the device will change direction. By rotating these pucks, you can define where the rollers will start and stop. Do this until you are familiar with how the sensors operate. **Refer to pages 12 and 13 in your operator's manual.**

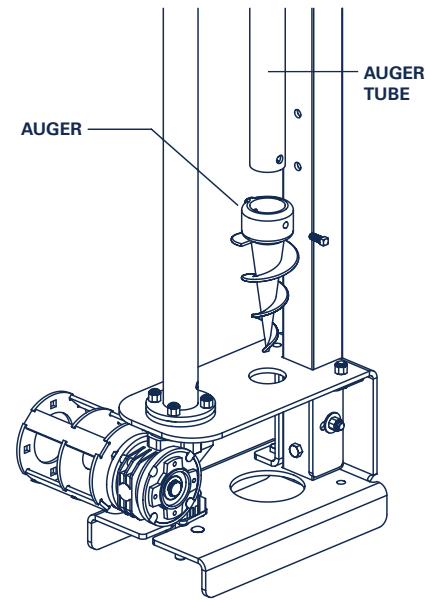

STEP 7:

Remove the auger from the auger tube using a 7/16-inch wrench.

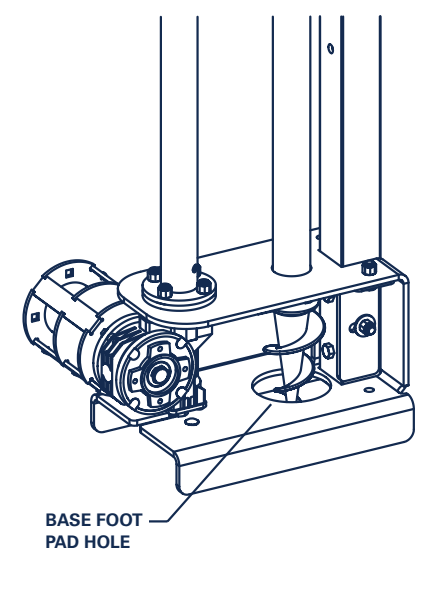

STEP 8:

Slide the auger tube through the base foot pad hole. Use the 7/16-inch wrench to reinstall the auger onto the auger tube.

Quick Reference Operator's Manual Page Numbers

Page 9	Electrical and Operational Safety
Page 11	Before Operating
Page 15	Installing the Lake Groomer
Page 18	Setting the Limits of Travel
Page 19	Dealing with Muck
Page 20-21	Enabling Extra Features
Page 22	Regular Maintenance and Off-Season Storage

Lake Groomer is a division of Eastside Machine Co.

800-234-7834

WWW.LAKEGROOMER.COM

© 2024 Eastside Machine Co. | P/N 700117